

Dear Youth Sports Director,

We need your help in spreading the word about the upcoming Town Meeting beginning next Monday, May 4<sup>th</sup>.

The Hopkinton Parks and Recreation Commission has an article on the Town Meeting schedule that is very important to all of your families and especially your children. We are asking all of our Youth Sports Directors to reach out to all of your participants and spread the word for the need for parents to show up to town meeting and vote in favor of the proposed Pavilion and Multi-Purpose facility.

As an overview, the Parks and Rec Commission has proposed to build a Pavilion at the Fruit Street Field Complex to provide a place for safety/shelter during inclement weather while participating in activities at Fruit Street. The project is planned to be developed in two phases. Phase 1 will be the Pavilion which will include a concessions stand, covered seating, bathrooms and storage space. Phase 2 will be an auxiliary indoor sports facility that will serve as a practice space for baseball, soccer, football, lacrosse and cheer. The goal is to provide a suitable space in Hopkinton for our kids to train and practice so they are not forced to drive to neighboring towns. Please see the attached plans for the project submitted by the engineering firm CDM Smith.

The request will be for \$500,000 to be financed over a 10 year period. The funds will be provided by the Community Preservation Committee.



Article 29 – Fruit Street Auxiliary Facility – construction – We expect this Article to be discussed and voted upon on Monday night, May 4. This is subject to change depending on the articles being presented before 29.

We will need many people in the audience to pass these articles and move forward with all of the phases of construction for the much needed Pavilion at Fruit Street Field Complex. Please feel free to contact the commission liaison for each sport. Bob Dobinski 508-958-8470 is the liaison for baseball and football, and Dan Terry 508-954-1173 is the liaison for soccer and lacrosse.

Sincerely,

Parks & Recreation

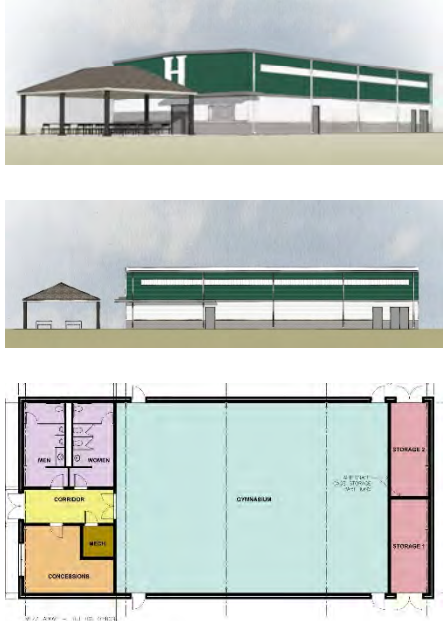
## Hopkinton Fruit Street Field House Concept Summary

	Full Program – One Height	Full Program – Two Heights	Reduced Program – One Height
			
Building Dimensions	99'L x 48'W x 20'H	99'L x 48'W x 20'H	90'L x 45'W x 20'H
Building Area w/o mezzanine(sf)	4,750	4,750	4,050
Future Mezzanine(sf)	950	n/a	880
Gymnasium Dimensions	65'L x 45'W	65'L x 45'W	65'L x 42'W
Restroom	3 Fixtures - Code plus 1	3 Fixtures - Code plus 1	2 Fixtures - Code
Separate Indoor Storage Area (sf)	405	405	n/a
Shade Shelter	37'L x 24'W	37'L x 24'W	37'L x 24'W

- A conservative number to carry for total project costs (including engineering fees) is \$220 - \$250/SF
- The “Full Program” Option pushes the budget limits. To come in at \$1,000,000 total cost (including consulting fees) the project costs need to be in the \$210/sq ft range. This may be low. Detailed design would explore all layout and materials and determine best options.
- Full program plan with lower roof presents some savings but not dollar for dollar in that most of the plan area is being built. Only saving some volume and exterior materials over the restroom/concession area.
- The Full Program, one height building allows for (future) mezzanine level above the restrooms and concession spaces.
- Indoor storage can be separated by masonry wall or simple wire cage partitions for additional cost savings. If walls are used, additional mezzanine storage could be provided.
- Reduced Program options eliminates one fixture in restrooms and allows building width to be reduced. This reduction could also be used in the Full Program option to reduce cost. It also eliminates indoor storage in favor of keeping the outdoor trailers. This option was explored to understand the potential cost savings.
- All options include a separate, prefabricated, open-air shade shelter. This is the most economical option for covered open space. Additional units can be purchased as budgets allow. A 24' x 37' structure will cost about \$45,000 - \$50,000. Additional structures could be located throughout the park as budget and future needs dictate.





210X360

FUTURE PLAYING FIELDS

75X120

75X120

150X210

75X120

FIELD HOUSE

FUTURE SHADE STRUCTURE

SHADE STRUCTURE

FUTURE SHADE STRUCTURE

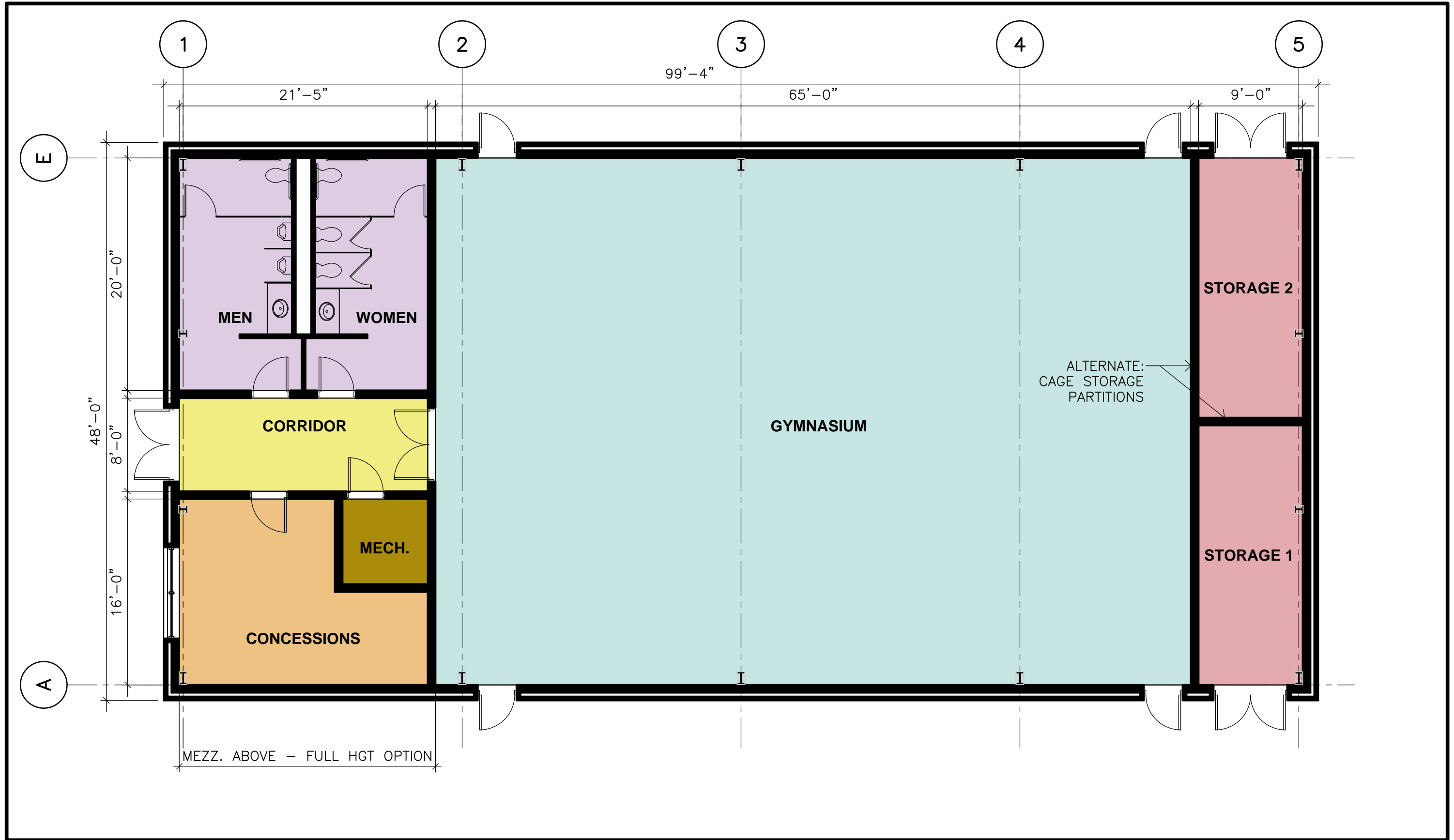



FULL PROGRAM OPTION - ONE HEIGHT BUILDING WITH SEPARATE SHADE STRUCTURE

FULL PROGRAM OPTION - ONE HEIGHT BUILDING WITH SEPARATE SHADE STRUCTURE





FULL PROGRAM OPTION - TWO HEIGHT\* BUILDING WITH SEPARATE SHADE STRUCTURE  
(Lower portion over restrooms and concessions)



FULL PROGRAM OPTION - TWO HEIGHT\* BUILDING WITH SEPARATE SHADE STRUCTURE  
(Lower portion over restrooms and concessions)



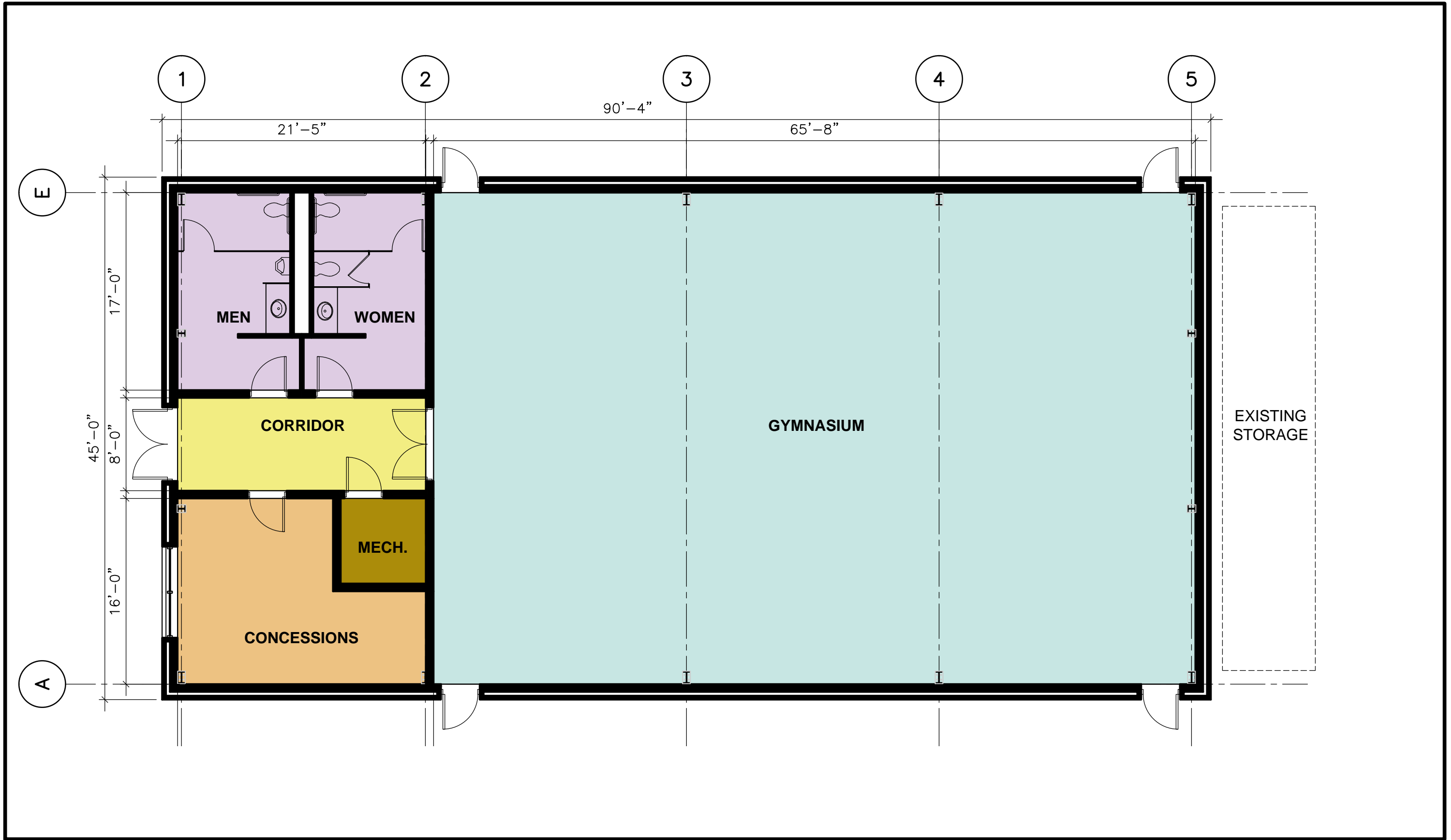

REDUCED PROGRAM OPTION - ONE HEIGHT BUILDING WITH SEPARATE SHADE STRUCTURE

